

CERTIFICATE OF LAND

File No.

Date:-

Certificate that the land measuring 16,180 Square Meters is owned by the Udit Rathi, Lakhan Rathi S/o Lonkendra Rathi & Ankur Rathi S/o Anand Rathi & Rajeev Rathi S/o Brajkishan Rathi by way of Gift Deed dated 28/07/2025.

It is further certified that owner of the land his leased the said land leased to **Rathi Educational Society** fully described in the schedule mentioned hereinafter with the following details of a period 29 years 11 Months from 28/07/2025 to 27.06.2054.

SL	Particulars	Details
1-	Khata No. 344 & 345 Khasra/Plot No. 450/1 & 450/4 Area/Rakva = 0.809 & 0.809 Hec	Book No. 1 Jild No 4906 Page 137 to 152 Registration No 4580 Dated 17-07-2021 At Sub - Registrar Jalesar (Etah) & Book No 1 Jild No 4906 Page 121 to 136 Registration No 4579 Dated 17/07/2021 At Sub-Registrar Jalesar (Etah)
2-	Village/Mauja Lakhmipur Pargana & Tahseel Jalesar District Etah	

It is certified that said entire land comprise of a single contiguous plot of land. It is further certified that **RATHI PUBLIC SCHOOL, VILLAGE LAKHMIPUR JALESAR (ETAH)** run by name of **RATHI EDUCATIONAL SOCIETY** is located on the said plot of land.

THE SCHEDULED OF LAND ABOVE REFERRED TO

All that piece and parcel of land measuring 16,180 Square meter situated in Plot/Khasra No. 450/1/0.809 Hec & 450/4/0.809 Hec at Village/Mouja Lakhimpur Pargana & Tahseel Jalesar District Etah and bounded as follows:

North : Agriculture Land Kalicharan Etc.
East : Agriculture Land Ramesh & Nekse Etc.
West : Link Road Jalesar Sikandrara
South : Chak Road

(Stamp and Signature of the land Authority)

(Name of the Officer)

(Name of the District)

Nisha
13/01/2026निशा लेखपाल
ब.व. - सतार
तहसील-जलेसर
जसद-एटा13-01-26
सुशील कुमार
30 नो जलेसर
जलेसरMANAGER
RATHI PUBLIC SCHOOL
JALESAR

SIGN.



महोदय,

गौजा लखमौपुर के गाटा स- 450 स/1. 618 ई. पर किराणे के अनुसार उपरोक्त शीफ मोनो फाउंडेशन लखमौपुर द्वारा उक्त में विचालप निर्मित है। जिसके पूरब में आराजी मेरुसे न सुरेश पश्चिम में सडक जलेसर-सिकन्दाराङ्ग मार्ग उत्तर में आराजी कालीचरन व दक्षिण में चकमासी स्थित है। दीर्घ सप्ती-चौदवी सही है। नजरी नक्शा प्रस्तुत करते हुए आरम्भ सेवा में सादां जेषित है।

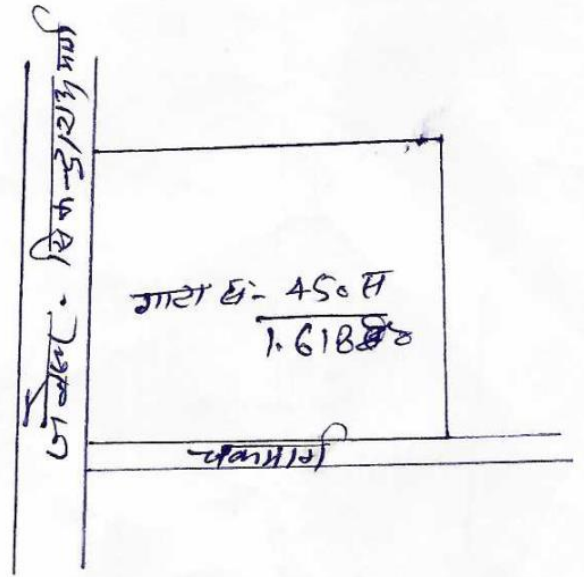
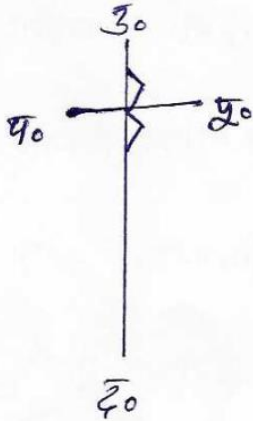

महोदय,

चकमासी कारखा संयुक्ति।

13-01-26
सुशील कुमार
रा० नि० जलेसर
तह० जलेसर

Nisha
13/01/2026
निशा लेखपाल
रा० चकमासी
तहसील-जलेसर
जनपद-राधा

13/01/26
73

